

## PRODUCT SPEC SHEET/KEY SPECIFICATIONS

### DORMER VENTS Model # DV2011 and DV2031

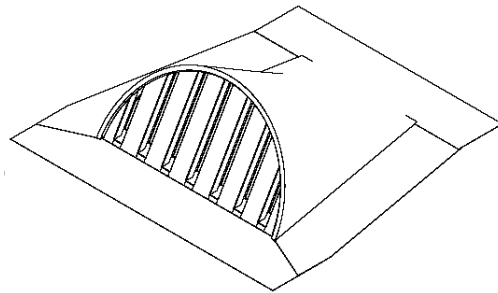
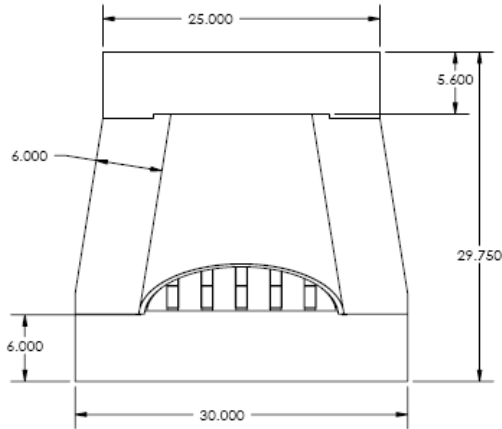

Under Eave/Soffit Vents	Model	Size W x H	NFVA Provided	Flanges Available	Flange Definition	Weight
	DV2011	9" x 18"	56	Standard	As Shown	15lbs
	DV2031	9" x 18"	56	Soft Aluminum	For "s" tiles	16lbs
CUSTOM SIZES and materials AVAILABLE						

### BENEFITS:

- Safety vents that are used in areas prone to wildfires, wind driven rain, or wind driven snow.
- Overlapping Baffle Protection ( Patent Pending )
  - Air Flows through normally
  - Resists the intrusion of Flame and Embers, Wind Driven Rain and Wind Driven Snow
- Compliant with new California Ch7a Building Code
- 20 Year Warranty
- Easy Install

#### STANDARD MATERIALS

Astm A653/A653M- G90 hot dipped galvanized steel, 26GA  
 ASTM D9092- mill phosphatized coating for painting. IF BONDERIZED  
 ASTM b370- Sheet Copper, 16oz and 20oz IF GALVANIZED  
 .025 x.025 hot dipped galvanized 23ga wire mesh

**Installation:** Install like any other similar Ventilator Product on the market.