

# PRODUCT SPEC SHEET/KEY SPECIFICATIONS

## Sub Base for DORMER, TURBINE, AND/OR OTHER FIELD VENTS Model # SB2021\*

**\*NOT TO BE USED WITH Brandguard Dormer Vents**

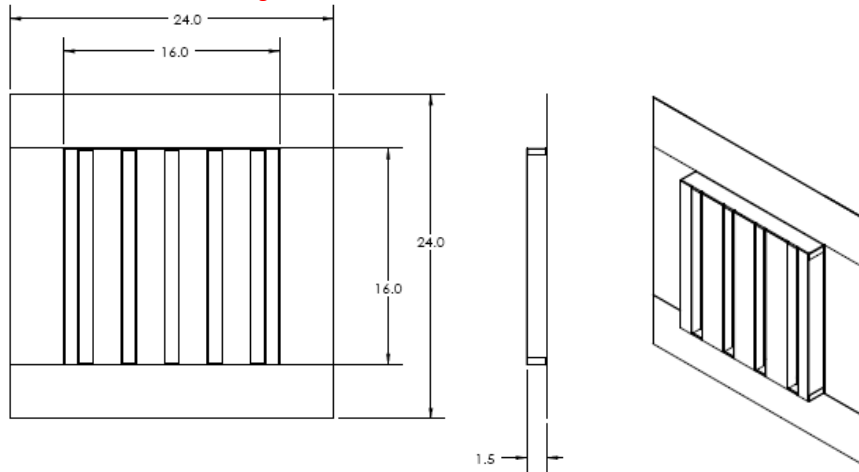

Sub Base for Dormer Vents	Model	Size W x H	NFVA Provided	Flanges Available	Flange Definition	Weight
* To be used with Dormer, Turbine, or other Field Vents	SB2021	16" x 16"	86	Standard	As Shown	6lbs
CUSTOM SIZES and materials AVAILABLE						

### BENEFITS:

- Safety vents that are used in areas prone to wildfires, wind driven rain, or wind driven snow.
- Overlapping Baffle Protection ( Patent Pending )
  - Air Flows through normally
  - Resists the intrusion of Flame and Embers, Wind Driven Rain and Wind Driven Snow
- Compliant with new California Ch7a Building Code
- 20 Year Warranty

#### STANDARD MATERIALS

Astm A653/A653M- G90 hot dipped galvanized steel, 26GA  
 ASTM D9092- mill phosphatized coating for painting. IF BONDERIZED  
 ASTM b370- Sheet Copper, 16oz and 20oz IF GALVANIZED  
 .025 x.025 hot dipped galvanized 23ga wire mesh

**Installation:** Install with Dormer, Turbine, Mushroom, or other applicable commodity field vents. Do NOT install with Brandguard Dormer Vent. Brandguard Dormer Vents can be used with a standard Mesh Sub Base